

QUESTIONS

INTENT

- › How shall St. George's sustain and evolve its mission into the future?

STEWARDSHIP

- › What is an appropriate synthesis of preservation and change?
- › What is a desirable approach to the graveyard and courtyard?

LOCATION

- › Is it important to have all current functions and activities on-site?
- › If any current or future activity were to move off-site, where would it go?

ACCESSIBILITY

- › How to make the facility as welcoming as the St. George's community?
- › Is it possible to (re)configure entrance(s) and improve internal circulation?

POSSIBILITIES

CHURCH

- › The Nave and Gallery are unchanged.
- › The North Narthex window is modified for a new accessible entrance.

SYDNOR HALL

- › The George Street entrance doors are made ADA compliant.
- › The Fellowship Hall is refined to improve larger and smaller group use.
- › A new passageway connects existing stair and lift for improved circulation.
- › Kitchen relocation enables functionality improvements to Fellowship Hall.
- › Storage is enlarged and reconfigured.

FAULKNER HALL

- › The Princess Anne Street entrance becomes the main Visitor Entrance.
- › Current Meeting Room becomes Reception and Administrative offices.

McGUIRE HALL

- › A new elevator connects all levels of McGuire and Faulkner Halls.
- › New Catechesis Atria spaces are added at 1 (no off-site space needed).
- › New Kitchen and Storage at 2 connect directly to Sydnor Hall.
- › New Meeting Room(s) at 2 expand outreach + admin capacity.
- › New Meeting Room + Terrace at 3 replace Faulkner Hall meeting space.
- › Selected interior renovations improve circulation and functionality.

GRAVEYARD + COURTYARD

- › Graves are surveyed, analyzed and a conservation plan is developed.
- › Graveyard is reduced in size by the addition to McGuire Hall.
- › A new Church entrance ramp is inserted into the corner of the Graveyard.

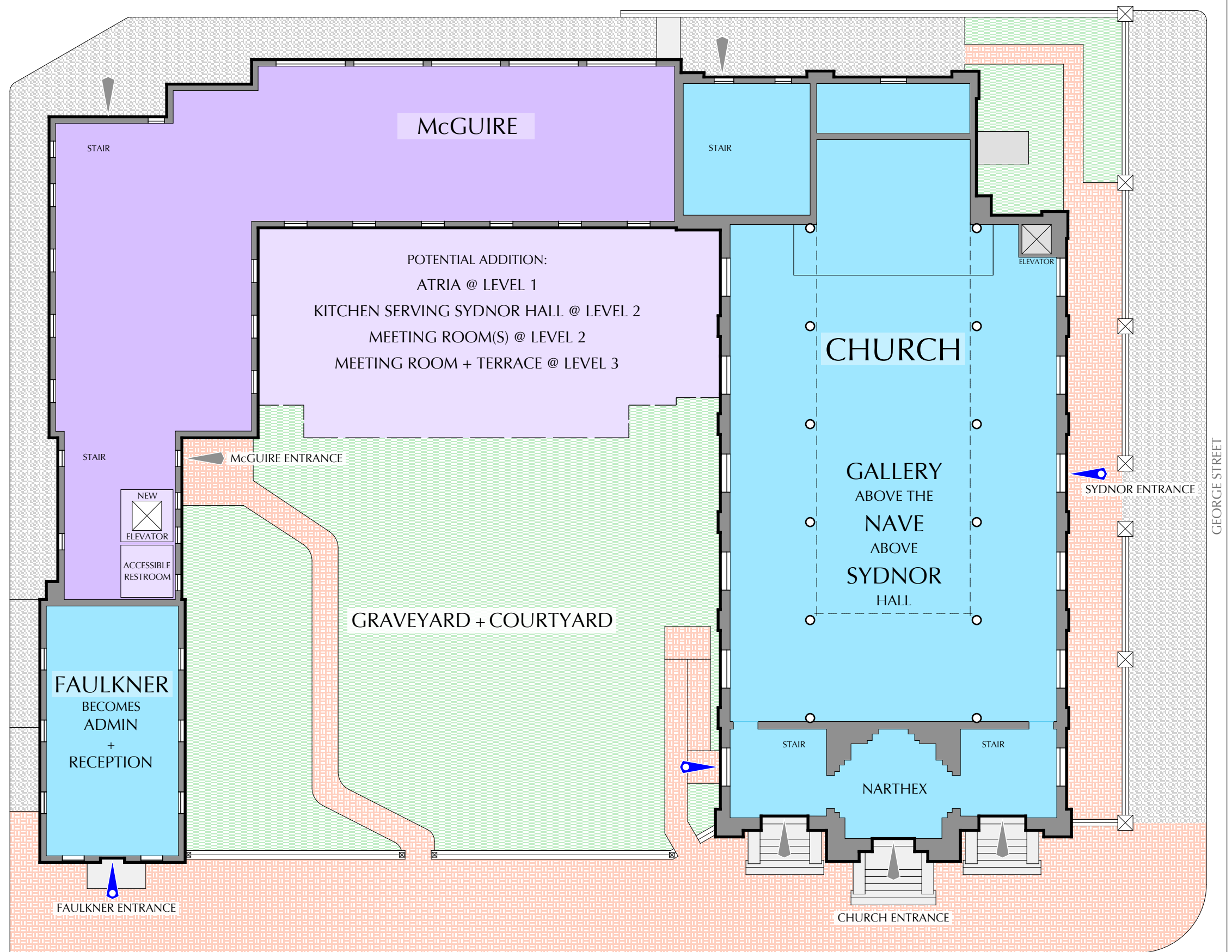

B